

THE LOFTS AT IRONBRIDGE

Next
REALTY
MID-ATLANTIC



**FOR GROUND
LEASE OR BUILT
TO SUIT**

0.95 - 1.6 ACRES
(FLEXIBLE ACREAGE AVAILABLE)

Iron Bridge Road &
Ironbridge Pkwy
Chester, VA

**JOIN NATIONAL
TENANTS:**





INTERESTED IN MORE INFORMATION?
CONTACT:

GRAY MCGREGOR:
gmcgregor@nextrealtymidatlantic.com
703.442.8834

DEMOGRAPHICS



	1 MILE	3 MILE	5 MILE
POPULATION 	4,706	31,154	74,215
HOUSEHOLDS 	1,818	11,908	27,334
MEDIAN HH INCOME 	\$80,737	\$84,106	\$84,664

2021 TRAFFIC COUNTS

IRONBRIDGE RD.....28,234 AADT

INTERESTED IN MORE INFORMATION?
CONTACT:

GRAY MCGREGOR:
gmcgregor@nextrealtymidatlantic.com
703.442.8834



<<< THE TRADE AREA >>>

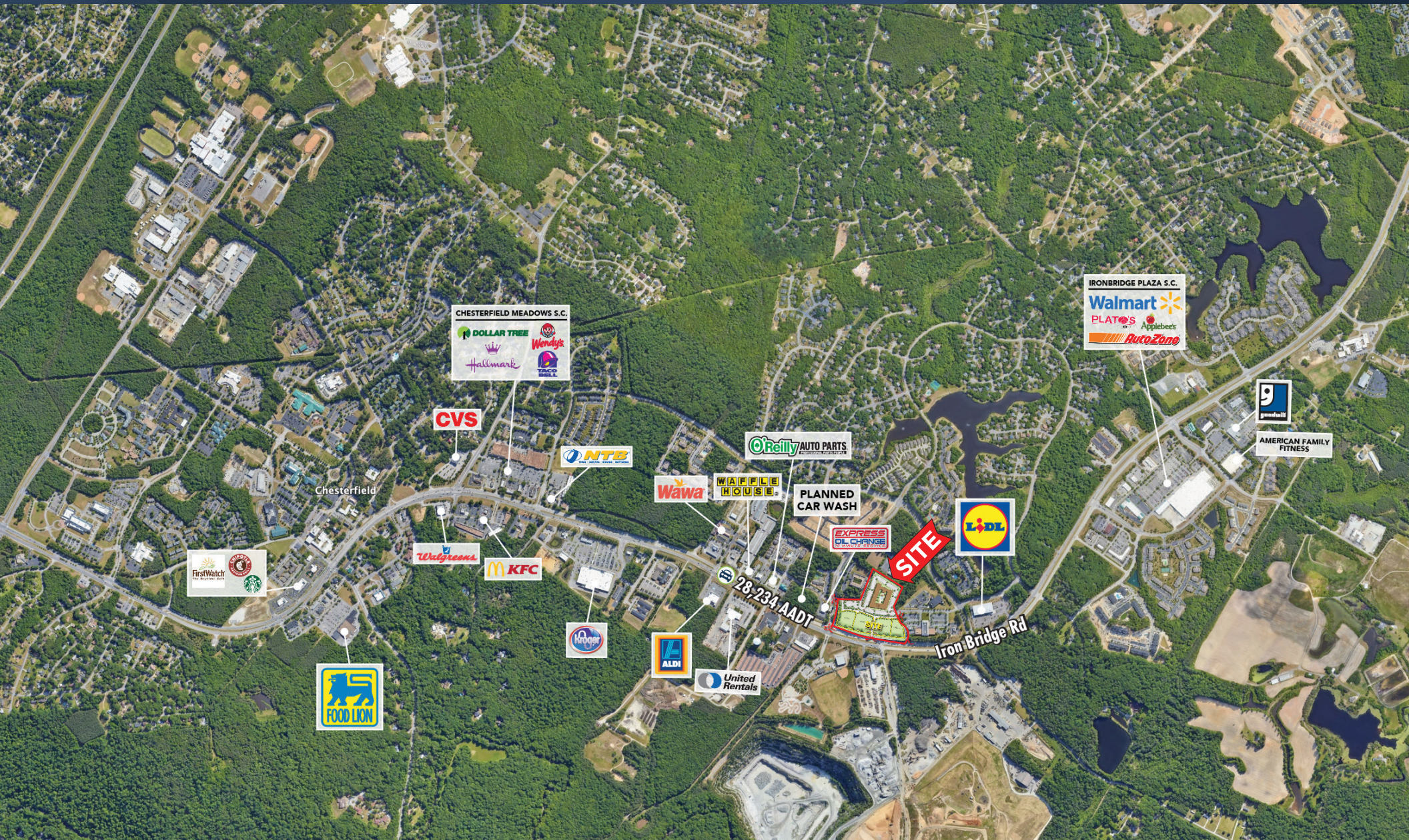

INTERESTED IN MORE INFORMATION?
CONTACT:

GRAY MCGREGOR:
gmcgregor@nextrealtymidatlantic.com
703.442.8834



<< SITE PLAN >>

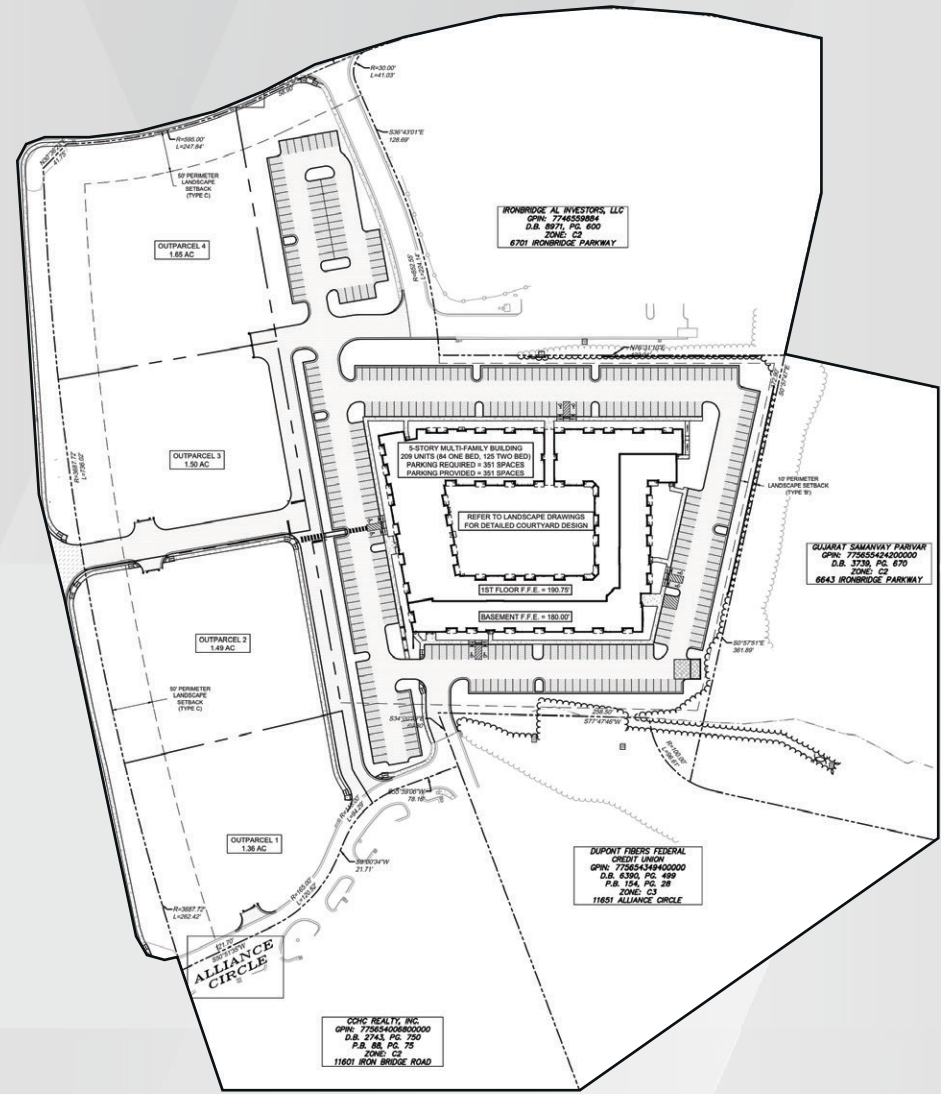

INTERESTED IN MORE INFORMATION?
 CONTACT:

GRAY MCGREGOR:
 gmgregor@nextrealtymidatlantic.com
 703.442.8834





<< THE LOFTS AT
IRON BRIDGE >>>

LOOKING FOR MORE INFORMATION?
CONTACT:

GRAY MCGREGOR:
gmcgregor@nextrealtymidatlantic.com
703.442.8834